

# Check Valves

10C, 10CO Series, 10,000 psig (690 bar)

15C, 15CO Series, 15,000 psig (1034 bar)

20C, 20CO Series, 20,000 psig (1379 bar)

60C, 60CO Series, 60,000 psig (4137 bar)



Medium & High Pressure  
Fittings and Tubing

Quick Couplings

Medium & High Pressure  
Valves

Line Filters

Sour Service Products

Subsea Valves

Tools and Installation  
Instructions

Technical Information

# Contents

## 10C Series

Pipe O-ring Check Valves	C-52
--------------------------	------

## 10CO Series

Pipe Ball Check Valves	C-53
------------------------	------

## 15C Series

O-ring Check Valves	C-54
---------------------	------

Pipe O-ring Check Valves	C-55
--------------------------	------

## 15CO Series

Ball Check Valves	C-56
-------------------	------

Pipe Ball Check Valves	C-57
------------------------	------

## 20C Series

O-ring Check Valves	C-58
---------------------	------

## 20CO Series

Ball Check Valves	C-59
-------------------	------

## 60C Series

O-ring Check Valves	C-60
---------------------	------

## 60CO Series

Ball Check Valves	C-61
-------------------	------

## Ordering Number Description

	C-62
--	------

# 10C Series

## 10,000 psig (690 bar)

### Pipe O-ring Check Valves

#### Features

- Fluorocarbon FKM O-ring for operation from 0°F to 400°F (-17.8°C to 204°C), other materials of O-rings available
- Cracking pressure: 14 psig~26 psig (0.966 bar~1.794 bar)
- Provides unidirectional flow and tight shut-off for liquids and gases with high reliability. When differential drops below cracking pressure, valve shuts off (Not for use as relief valve)
- Resilient O-ring seat design for noise-free closing and zero leakage

#### Standard Materials of Construction

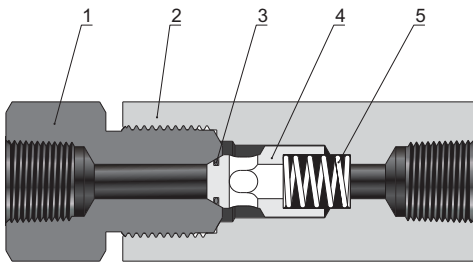

Item	Component	Material Grade/ASTM Specification
1	<i>Cover Gland</i>	<i>316 SS/A479</i>
2	<i>Valve Body</i>	<i>316 SS/A479</i>
3	<i>O-ring</i>	<i>Fluorocarbon FKM</i>
4	<i>Poppet</i>	<i>316 SS/A479</i>
5	<i>Spring</i>	<i>300 Series Stainless Steel</i>
	Lubricant	Molybdenum Disulfide/Fluorinated-based

*Wetted components listed in italics.*

#### Ordering Information and Dimensions

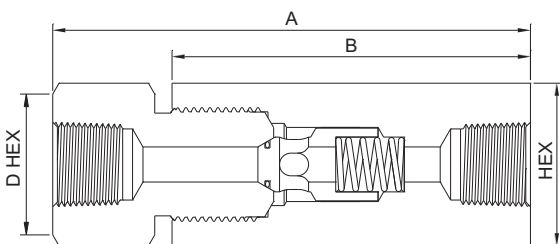

Ordering Number	Connection	Orifice in. (mm)	Cv	Dimensions, in. (mm)				Working Pressure psig (bar)
				A	B	D - HEX	HEX	
10CSS-FNS12	FNS12	0.52 (13.21)	4.70	6.11 (155.3)	4.75 (120.7)	1.5 (38.1)	1.75 (44.5)	10,000 (690)
10CSS-FNS16	FNS16	0.69 (17.53)	7.40	7.33 (186.2)	5.75 (146.1)	1.75 (44.5)	1.88 (47.8)	10,000 (690)

NOTE: For other pipe connections, please refer to 15C Series Pipe O-ring Check Valves for details.

# 10CO Series

## 10,000 psig (690 bar)

### Pipe Ball Check Valves

#### Features

- ⦿ Working temperature range: -110°F to 400°F (-79°C to 204°C)
- ⦿ Prevents reverse flow where leak-tight shut-off is not mandatory (Not for use as relief valve)
- ⦿ An integral design of the ball and poppet to assure positive, in-line seating without "chatter".  
Poppet designed essentially for axial flow with minimum pressure drop
- ⦿ Optional wetted materials of cover gland and ball poppet for longer life

#### Standard Materials of Construction

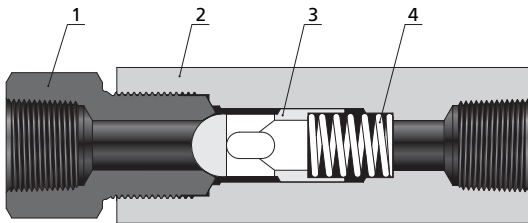

Item	Component	Material Grade/ASTM Specification
1	<i>Cover Gland</i>	<i>316 SS/A479</i>
2	<i>Valve Body</i>	<i>316 SS/A479</i>
3	<i>Ball Poppet</i>	<i>316 SS/A479</i>
4	<i>Spring</i>	<i>300 Series Stainless Steel</i>
	Lubricant	Molybdenum Disulfide/Fluorinated-based

*Wetted components listed in italics.*

#### Ordering Information and Dimensions

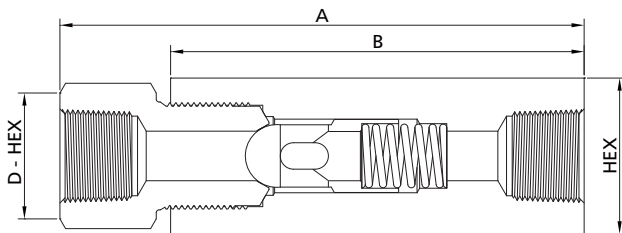

Ordering Number	Connection	Orifice in. (mm)	Cv	Dimensions, in. (mm)				Working Pressure psig (bar)
				A	B	D - HEX	HEX	
10COSS-FNS12	FNS12	0.52 (13.21)	4.70	6.11 (155.3)	4.75 (120.7)	1.5 (38.1)	1.75 (44.5)	10,000 (690)
10COSS-FNS16	FNS16	0.69 (17.53)	7.40	7.33 (186.2)	5.75 (146.1)	1.75 (44.5)	1.88 (47.8)	10,000 (690)

NOTE: For other pipe connections, please refer to 15CO Series Pipe Ball Check Valves for details.

# 15C Series

## 15,000 psig (1034 bar)

### O-ring Check Valves

#### Features

- ⦿ Fluorocarbon FKM O-ring for operation from 0°F to 400°F (-17.8°C to 204°C), other materials of O-rings available
- ⦿ Tubing sizes available in 1/4", 3/8" and 1/2"
- ⦿ Cracking pressure: 14 psig~26 psig (0.966 bar~1.794 bar)
- ⦿ Provides unidirectional flow and tight shut-off for liquids and gases with high reliability. When differential drops below cracking pressure, valve shuts off (Not for use as relief valve)
- ⦿ Resilient O-ring seat design for noise-free closing and zero leakage

#### Standard Materials of Construction

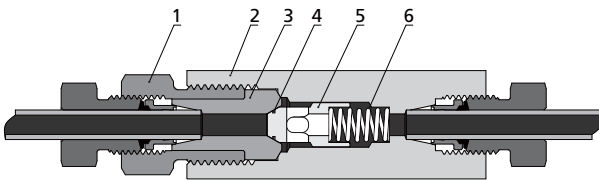

Item	Component	Material Grade/ASTM Specification
1	Cover Gland	316 SS/A479
2	Valve Body	316 SS/A479
3	Cover	316SS/A479
4	O-ring	Fluorocarbon FKM
5	Poppet	316 SS/A479
6	Spring	300 Series Stainless Steel
Lubricant		Molybdenum Disulfide/Fluorinated-based

*Wetted components listed in italics.*

#### Ordering Information and Dimensions

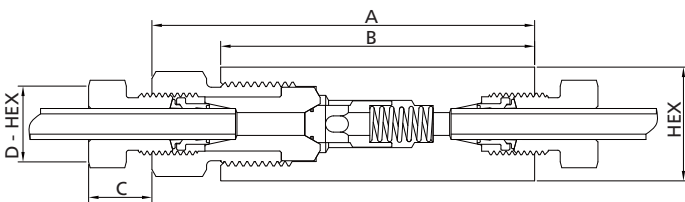

Ordering Number	Connection	Orifice in. (mm)	Cv	Dimensions, in. (mm)					Working Pressure psig (bar)
				A	B	C	D - HEX	HEX	
15CSS-DHL4	DHL4	0.188 (4.78)	0.63	3.35 (85)	2.72 (69.2)	0.52 (13.3)	0.63 (16.0)	0.81 (20.6)	15,000 (1034)
15CSS-DHL6	DHL6	0.250 (6.35)	1.70	3.72 (94.6)	3.13 (79.6)	0.53 (13.5)	0.75 (19.1)	1.00 (25.4)	15,000 (1034)
15CSS-DHL8	DHL8	0.375 (9.53)	3.40	4.41 (112.0)	3.68 (93.5)	0.60 (15.3)	0.93 (23.6)	1.38 (35.1)	15,000 (1034)

## Pipe O-ring Check Valves

### Features

- Fluorocarbon FKM O-ring for operation from 0°F to 400°F (-17.8°C to 204°C), other materials of O-rings available
- Cracking pressure: 14 psig~26 psig (0.966 bar~1.794 bar)
- Provides unidirectional flow and tight shut-off for liquids and gases with high reliability. When differential drops below cracking pressure, valve shuts off (Not for use as relief valve)
- Resilient O-ring seat design for noise-free closing and zero leakage

### Standard Materials of Construction

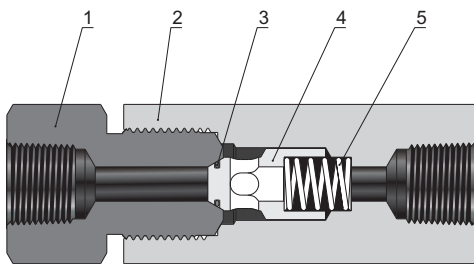

Item	Component	Material Grade/ASTM Specification
1	<i>Cover Gland</i>	<i>316 SS/A479</i>
2	<i>Valve Body</i>	<i>316 SS/A479</i>
3	<i>O-ring</i>	<i>Fluorocarbon FKM</i>
4	<i>Poppet</i>	<i>316 SS/A479</i>
5	<i>Spring</i>	<i>300 Series Stainless Steel</i>
	Lubricant	Molybdenum Disulfide/Fluorinated-based

*Wetted components listed in italics.*

### Ordering Information and Dimensions

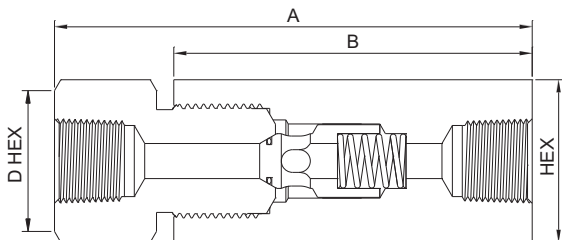

Ordering Number	Connection	Orifice in. (mm)	Cv	Dimensions, in. (mm)				Working Pressure psig (bar)
				A	B	D - HEX	HEX	
15CSS-FNS4	FNS4	0.12 (3.05)	0.28	3.30 (83.8)	2.38 (60.3)	0.94 (23.8)	0.94 (23.8)	15,000 (1034)
15CSS-FNS6	FNS6	0.22 (5.59)	0.84	3.95 (100.3)	2.88 (73.2)	1.13 (28.6)	1.13 (28.6)	15,000 (1034)
15CSS-FNS8	FNS8	0.36 (9.12)	2.30	5.07 (128.9)	3.88 (98.6)	1.38 (34.9)	1.38 (34.9)	15,000 (1034)

# 15CO Series

## 15,000 psig (1034 bar)

### Ball Check Valves

#### Features

- ⦿ Working temperature range: -110°F to 800°F (-79°C to 427°C)
- ⦿ Tubing sizes available in 1/4", 3/8" and 1/2"
- ⦿ Prevents reverse flow where leak-tight shut-off is not mandatory (Not for use as relief valve)
- ⦿ An integral design of the ball and poppet to assure positive, in-line seating without "chatter".  
 Poppet designed essentially for axial flow with minimum pressure drop
- ⦿ Optional wetted materials of cover gland and ball poppet for longer life

#### Standard Materials of Construction

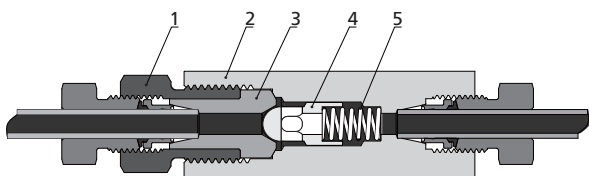

Item	Component	Material Grade/ASTM Specification
1	Cover Gland	316 SS/A479
2	Valve Body	316 SS/A479
3	Cover	316 SS/A479
4	Ball Poppet	316 SS/A479
5	Spring	300 Series Stainless Steel
	Lubricant	Molybdenum Disulfide/Fluorinated-based

*Wetted components listed in italics.*

#### Ordering Information and Dimensions

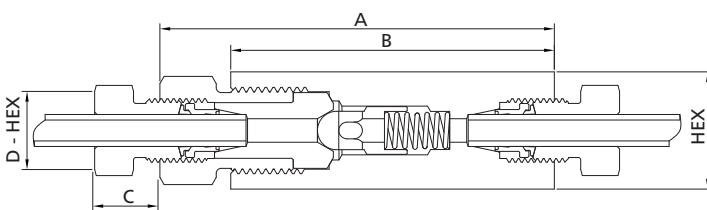

Ordering Number	Connection	Orifice in. (mm)	Cv	Dimensions, in. (mm)					Working Pressure psig (bar)
				A	B	C	D - HEX	HEX	
15COSS-DHL4	DHL4	0.188 (4.78)	0.63	3.35 (85)	2.72 (69.2)	0.52 (13.3)	0.63 (16.0)	0.81 (20.6)	15,000 (1034)
15COSS-DHL6	DHL6	0.250 (6.35)	1.70	3.72 (94.6)	3.13 (79.6)	0.53 (13.5)	0.75 (19.1)	1.00 (25.4)	15,000 (1034)
15COSS-DHL8	DHL8	0.375 (9.53)	3.40	4.41 (112.0)	3.68 (93.5)	0.60 (15.3)	0.93 (23.6)	1.38 (35.1)	15,000 (1034)

# Pipe Ball Check Valves

## Features

- ⦿ Working temperature range: -110°F to 400°F (-79°C to 204°C)
- ⦿ Prevents reverse flow where leak-tight shut-off is not mandatory (Not for use as relief valve)
- ⦿ An integral design of the ball and poppet to assure positive, in-line seating without "chatter".  
 Poppet is designed essentially for axial flow with minimum pressure drop
- ⦿ Optional wetted materials of cover gland and ball poppet for longer life

## Standard Materials of Construction

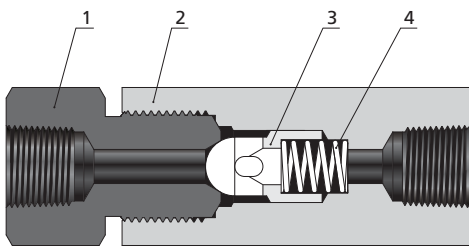

Item	Component	Material Grade/ASTM Specification
1	<i>Cover Gland</i>	<i>316 SS/A479</i>
2	<i>Valve Body</i>	<i>316 SS/A479</i>
3	<i>Ball Poppet</i>	<i>316 SS/A479</i>
4	<i>Spring</i>	<i>300 Series Stainless Steel</i>
	Lubricant	Molybdenum Disulfide/Fluorinated-based

*Wetted components listed in italics.*

## Ordering Information and Dimensions

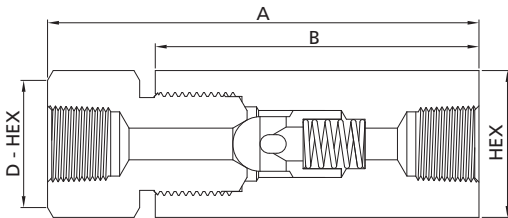

Ordering Number	Connection	Orifice in. (mm)	Cv	Dimensions, in. (mm)				Working Pressure psig (bar)
				A	B	D - HEX	HEX	
15COSS-FNS4	FNS4	0.12 (3.05)	0.28	3.30 (83.8)	2.38 (60.3)	0.94 (23.8)	0.94 (23.8)	15,000 (1034)
15COSS-FNS6	FNS6	0.22 (5.59)	0.84	3.95 (100.3)	2.88 (73.2)	1.13 (28.6)	1.13 (28.6)	15,000 (1034)
15COSS-FNS8	FNS8	0.36 (9.12)	2.30	5.07 (128.9)	3.88 (98.6)	1.38 (34.9)	1.38 (34.9)	15,000 (1034)

Medium & High Pressure Fittings and Tubing  
 Quick Couplings  
 Medium & High Pressure Valves  
 Line Filters  
 Sour Service Products  
 Subsea Valves  
 Tools and Installation Instructions  
 Technical Information



# 20C Series

## 20,000 psig (1379 bar)

### O-ring Check Valves

#### Features

- Fluorocarbon FKM O-ring for operation from 0°F to 400°F (-17.8°C to 204°C), other materials of O-rings available
- Tubing sizes available from 1/4" to 1"
- Cracking pressure: 14 psig~26 psig (0.966 bar~1.794 bar)
- Provides unidirectional flow and tight shut-off for liquids and gases with high reliability. When differential drops below cracking pressure, valve shuts off (Not for use as relief valve)
- Resilient O-ring seat design for noise-free closing and zero leakage

#### Standard Materials of Construction

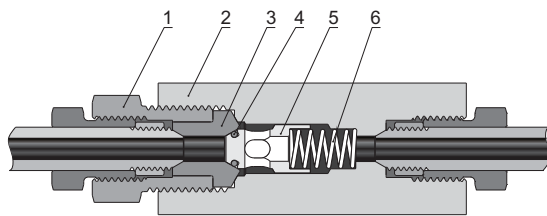

Item	Component	Material Grade/ASTM Specification
1	Cover Gland	316 SS/A479
2	Valve Body	316 SS/A479
3	Cover	316 SS/A479
4	O-ring	Fluorocarbon FKM
5	Poppet	316 SS/A479
6	Spring	300 Series Stainless Steel
	Lubricant	Molybdenum Disulfide/Fluorinated-based

Wetted components listed in italics.

#### Ordering Information and Dimensions

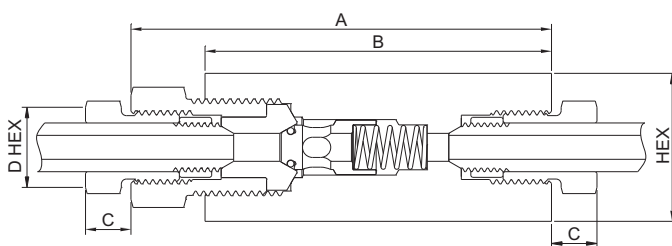

Ordering Number	Connection	Orifice in. (mm)	Cv	Dimensions, in. (mm)					Working Pressure psig (bar)
				A	B	C	D - HEX	HEX	
20CSS-2FH4	2FH4	0.125 (3.18)	0.28	2.94 (74.7)	2.50 (63.5)	0.38 (9.7)	0.50 (12.7)	0.81 (20.6)	20,000 (1379)
20CSS-2FH6	2FH6	0.218 (5.54)	0.84	3.12 (79.3)	2.62 (66.6)	0.44 (11.2)	0.62 (15.8)	1.00 (25.4)	20,000 (1379)
20CSS-2FH9	2FH9	0.359 (9.12)	2.30	4.18 (106.2)	3.50 (88.9)	0.55 (14.0)	0.94 (23.9)	1.38 (35.1)	20,000 (1379)
20CSS-2FH12	2FH12	0.516 (13.11)	4.70	5.50 (139.7)	4.75 (120.7)	0.60 (15.2)	1.19 (30.2)	1.75 (44.5)	20,000 (1379)
20CSS-2FH16	2FH16	0.688 (17.48)	7.40	6.91 (175.6)	5.75 (146.1)	0.74 (18.8)	1.38 (35.1)	2.12 (53.9)	20,000 (1379)

# 20CO Series

## 20,000 psig (1379 bar)

### Ball Check Valves

#### Features

- ⦿ Working temperature range: -110°F to 1200°F (-79°C to 649°C)
- ⦿ Tubing sizes available from 1/4" to 1"
- ⦿ Prevents reverse flow where leak-tight shut-off is not mandatory (Not for use as relief valve)
- ⦿ An integral design of the ball and poppet to assure positive, in-line seating without "chatter".  
Poppet is designed essentially for axial flow with minimum pressure drop
- ⦿ Optional wetted materials of cover gland and ball poppet for longer life

#### Standard Materials of Construction

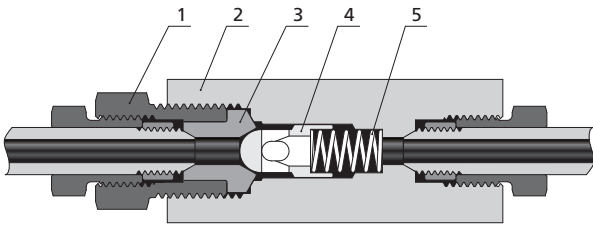

Item	Component	Material Grade/ASTM Specification
1	Cover Gland	316 SS/A479
2	Valve Body	316 SS/A479
3	Cover	316 SS/A479
4	Ball Poppet	316 SS/A479
5	Spring	300 Series Stainless Steel
	Lubricant	Molybdenum Disulfide/Fluorinated-based

*Wetted components listed in italics.*

#### Ordering Information and Dimensions

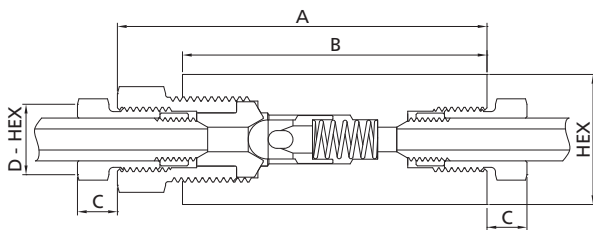

Ordering Number	Connection	Orifice in. (mm)	Cv	Dimensions, in. (mm)					Working Pressure psig (bar)
				A	B	C	D - HEX	HEX	
20COSS-2FH4	2FH4	0.125 (3.18)	0.28	2.94 (74.7)	2.50 (63.5)	0.38 (9.7)	0.50 (12.7)	0.81 (20.6)	20,000 (1379)
20COSS-2FH6	2FH6	0.218 (5.54)	0.84	3.12 (79.3)	2.62 (66.6)	0.44 (11.2)	0.62 (15.8)	1.00 (25.4)	20,000 (1379)
20COSS-2FH9	2FH9	0.359 (9.12)	2.30	4.18 (106.2)	3.50 (88.9)	0.55 (14.0)	0.94 (23.9)	1.38 (35.1)	20,000 (1379)
20COSS-2FH12	2FH12	0.516 (13.11)	4.70	5.50 (139.7)	4.75 (120.7)	0.60 (15.2)	1.19 (30.2)	1.75 (44.5)	20,000 (1379)
20COSS-2FH16	2FH16	0.688 (17.48)	7.40	6.91 (175.6)	5.75 (146.1)	0.74 (18.8)	1.38 (35.1)	2.12 (53.9)	20,000 (1379)

# 60C Series

## 60,000 psig (4137 bar)

### O-ring Check Valves

#### Features

- Fluorocarbon FKM O-ring for operation from 0°F to 400°F (-17.8°C to 204°C), other materials of O-rings available
- Tubing sizes available from 1/4" to 9/16"
- Cracking pressure: 14 psig~26 psig (0.966 bar~1.794 bar)
- Provides unidirectional flow and tight shut-off for liquids and gases with high reliability. When differential drops below cracking pressure, valve shuts off (Not for use as relief valve)
- Resilient O-ring seat design for noise-free closing and zero leakage

#### Standard Materials of Construction

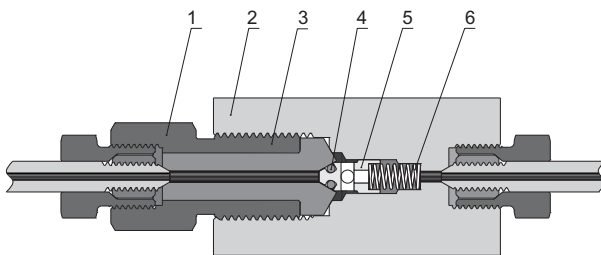

Item	Component	Material Grade/ASTM Specification
1	Cover Gland	316 SS/A479
2	Valve Body	316 SS/A479
3	Cover	316 SS/A479
4	O-ring	Fluorocarbon FKM
5	Poppet	316 SS/A479
6	Spring	300 Series Stainless Steel
	Lubricant	Molybdenum Disulfide/Fluorinated-based

*Wetted components listed in italics.*

#### Ordering Information and Dimensions

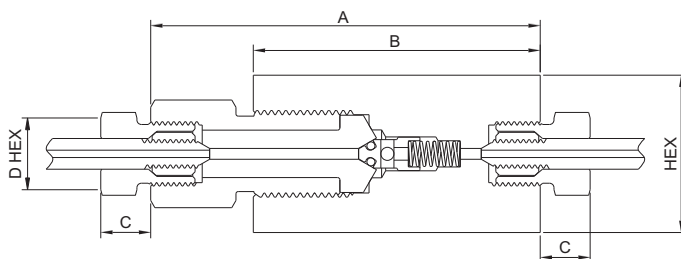

Ordering Number	Connection	Orifice in. (mm)	Cv	Dimensions, in. (mm)					Working Pressure psig (bar)
				A	B	C	D - HEX	HEX	
60CSS-6FH4	6FH4	0.094 (2.39)	0.15	3.38 (85.9)	2.50 (63.5)	0.47 (11.9)	0.63 (16.0)	1.18 (30.0)	60,000 (4137)
60CSS-6FH6	6FH6	0.125 (3.18)	0.28	3.86 (98.1)	2.80 (71.1)	0.61 (15.5)	0.81 (20.6)	1.18 (30.0)	60,000 (4137)
60CSS-6FH9	6FH9	0.187 (4.75)	0.63	4.62 (117.4)	3.38 (85.9)	0.95 (24.1)	1.12 (28.5)	1.50 (38.1)	60,000 (4137)

# 60CO Series

## 60,000 psig (4137 bar)

### Ball Check Valves

#### Features

- Working temperature range: -110°F to 1200°F (-79°C to 649°C)
- Tubing sizes available from 1/4" to 9/16"
- Prevents reverse flow where leak-tight shut-off is not mandatory (Not for use as relief valve)
- An integral design of the ball and poppet to assure positive, in-line seating without "chatter".  
Poppet is designed essentially for axial flow with minimum pressure drop
- Optional wetted materials of cover gland and ball poppet for longer life

#### Standard Materials of Construction

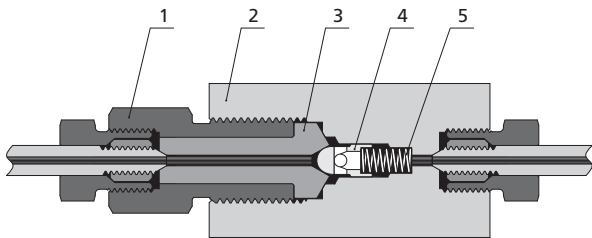

Item	Component	Material Grade/ASTM Specification
1	Cover Gland	316 SS/A479
2	Valve Body	316 SS/A479
3	Cover	316 SS/A479
4	Ball Poppet	316 SS/A479
5	Spring	300 Series Stainless Steel
	Lubricant	Molybdenum Disulfide/Fluorinated-based

*Wetted components listed in italics.*

#### Ordering Information and Dimensions

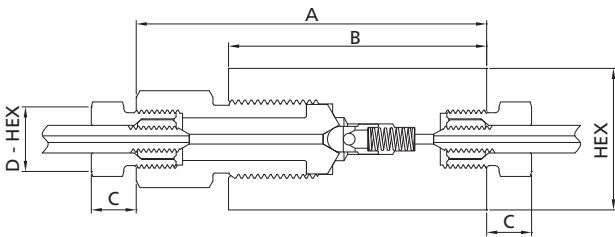

Ordering Number	Connection	Orifice in. (mm)	Cv	Dimensions, in. (mm)					Working Pressure psig (bar)
				A	B	C	D - HEX	HEX	
60COSS-6FH4	6FH4	0.094 (2.39)	0.15	3.38 (85.9)	2.50 (63.5)	0.47 (11.9)	0.63 (16.0)	1.18 (30.0)	60,000 (4137)
60COSS-6FH6	6FH6	0.125 (3.18)	0.28	3.86 (98.1)	2.80 (71.1)	0.61 (15.5)	0.81 (20.6)	1.18 (30.0)	60,000 (4137)
60COSS-6FH9	6FH9	0.187 (4.75)	0.63	4.62 (117.4)	3.38 (85.9)	0.95 (24.1)	1.12 (28.5)	1.50 (38.1)	60,000 (4137)

NOTE: All dimensions are for reference only and are subject to change. For dimensions not shown above, please contact FITOK Group or our authorized distributors.

Medium & High Pressure Fittings and Tubing

Quick Couplings

Medium & High Pressure Valves

Line Filters

Sour Service Products

Subsea Valves

Tools and Installation Instructions

Technical Information

## Ordering Number Description

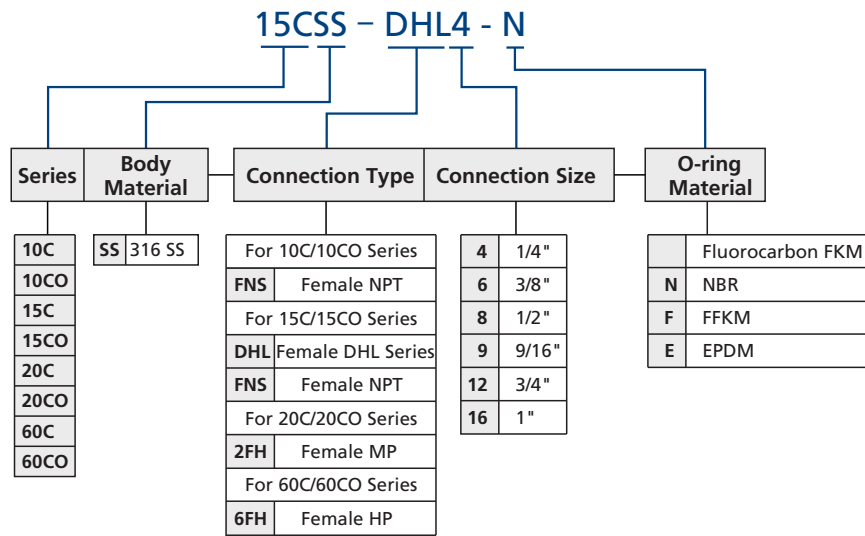

- NOTES: 1. "Ordering Number Description" is a reference to understand the combination rules of FITOK product part number. Not all combinations are available.
2. For products applied under lower temperature, please contact FITOK Group or our authorized distributors.

Code	O-ring Material	Working Temperature Range, °F (°C)
	Fluorocarbon FKM	0 to 400 (-17.8 to 204)
N	NBR	-10 to 250 (-23 to 121)
F	FFKM	-20 to 550 (-29 to 288)
E	EPDM	-50 to 300 (-45 to 148)

Medium & High Pressure Fittings and Tubing

Quick Couplings

Medium & High Pressure Valves

Line Filters

Sour Service Products

Subsea Valves

Tools and Installation Instructions

Technical Information

## **FITOK Group**

### **FITOK GmbH (Headquarter)**

Sprendlinger Landstr. 115, 63069 Offenbach am Main, Germany  
Tel.: +49 69 8900 4498 Fax: +49 69 8900 4495

### **FITOK, Inc.**

13843 North Promenade Blvd., Suite 750, Stafford, Texas 77477, USA  
Tel.: +1 281 888 0077 Fax: +1 281 582 4051

### **FITOK Incorporated**

1-4F, Block C, Zone E, Yingtailong Industrial Park, Dalang Street,  
Longhua District, Shenzhen, 518109, China  
Tel.: +86 755 2803 2500 Fax: +86 755 2803 2619

### **FITOK Middle East Oil Equipment Trading LLC**

208-209, Makateb Tower, Airport Road, P.O.Box 185412, Deira, Dubai, UAE  
Tel.: +971 4 2959 853 Fax: +971 4 2959 854

[info@fitokgroup.com](mailto:info@fitokgroup.com)  
[www.fitokgroup.com](http://www.fitokgroup.com)

FK-IC-HV-03-EN-170505